

Notes:
 Minimum Wall Thickness 5.5mm
 Anti-Static Internal Face

For reference purposes only.
 This drawing is not a specification.

Category:	HEIGHT ADJUSTABLE ROUND SUMP SYSTEMS	
Product Description:	47" diameter base chamber with a sealed corbel, adjustable skirt and round 36" flat sealed cover. Round tank flange.	
Drawing No:	US21045	Product Code S8-390/SEAL
Date:	July 2003	Revisions: 0

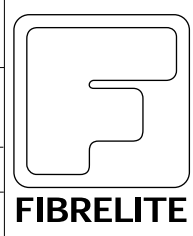

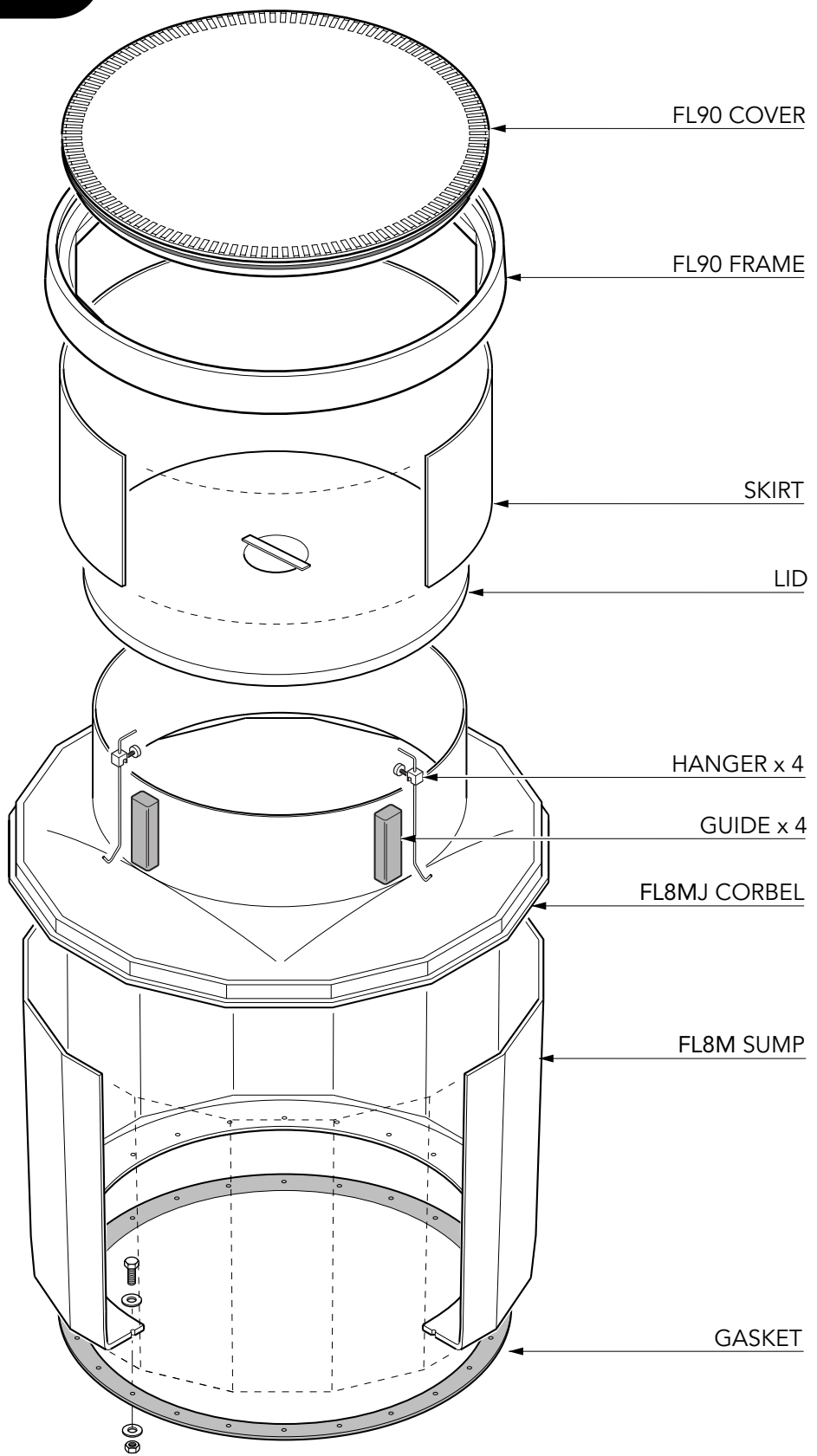

Notes:
 Minimum Wall Thickness 5.5mm
 Anti-Static Internal Face

For reference purposes only.
 This drawing is not a specification.

Category:	HEIGHT ADJUSTABLE ROUND SUMP SYSTEMS	
Product Description:	47" diameter base sump with a sealed corbel, adjustable skirt and round 36" flat sealed cover. Round tank flange.	
Drawing No:	US21222	Product Code S8-390/SEAL
Date:	July 2003	Revisions: 0

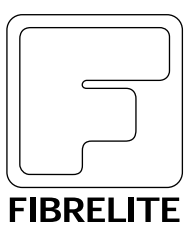



VERY IMPORTANT
 OUTER EDGE "A" OF FRAME SET 1/4 - 1/2
 ABOVE GENERAL GRADE AREA WITH
 CONCRETE RAMPED AWAY OVER 12".

TYPICAL INSTALLATION

CONCRETE

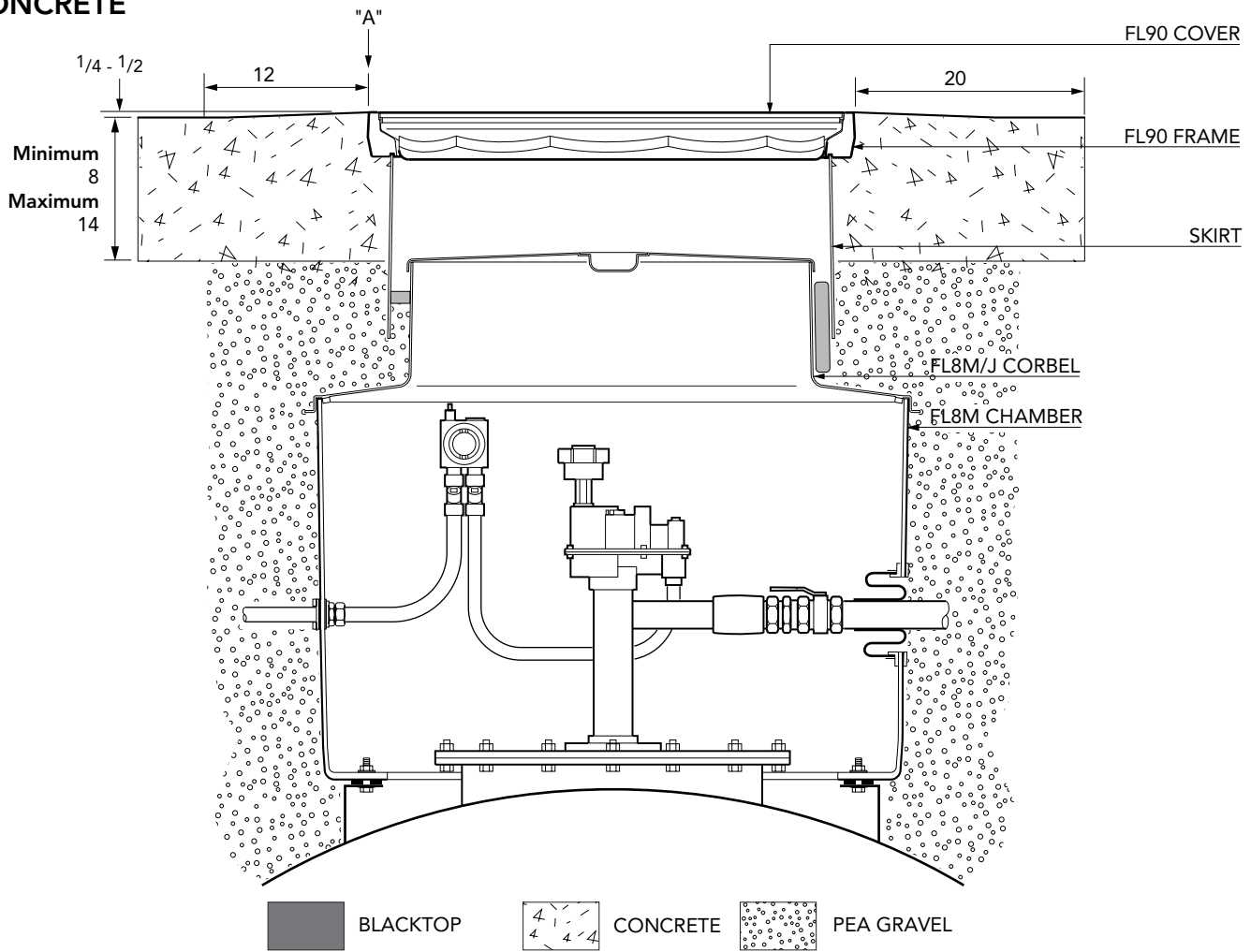

ALTERNATIVE INSTALLATION ADVICE

BLACKTOP

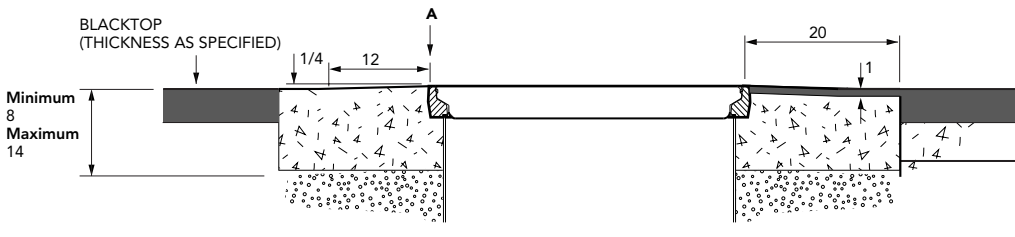

Notes:
 Minimum Wall Thickness 5.5mm
 Anti-Static Internal Face

For reference purposes only.
 This drawing is not a specification.

Category:	HEIGHT ADJUSTABLE ROUND SUMP SYSTEMS	
Product Description:	47" diameter base sump with a sealed corbel, adjustable skirt and round 36" flat sealed cover. Round tank flange.	
Drawing No:	US21223	Product Code S8-390/SEAL
Date:	July 2003	Revisions: 0

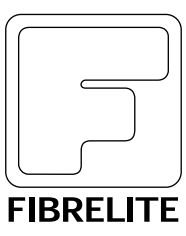

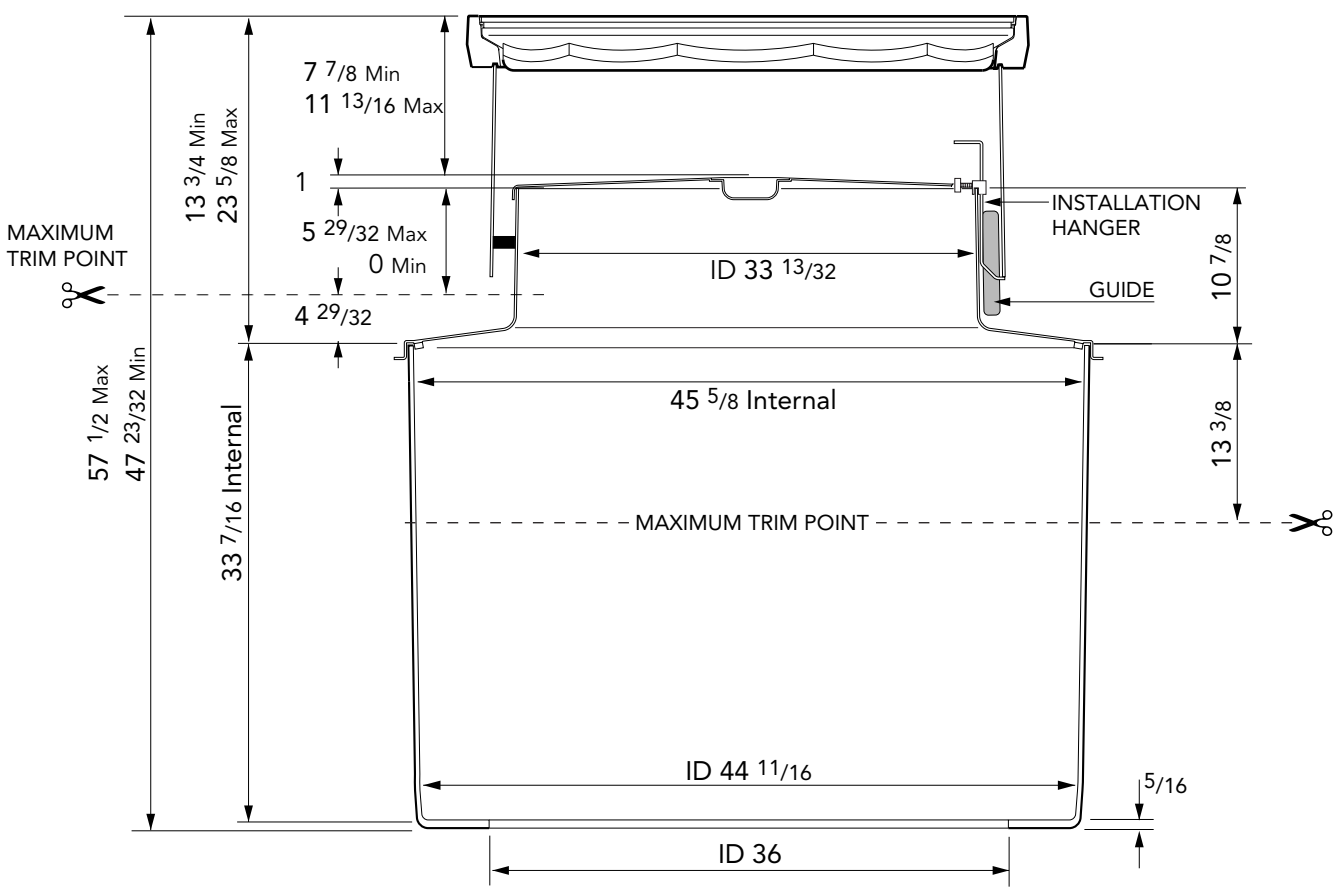
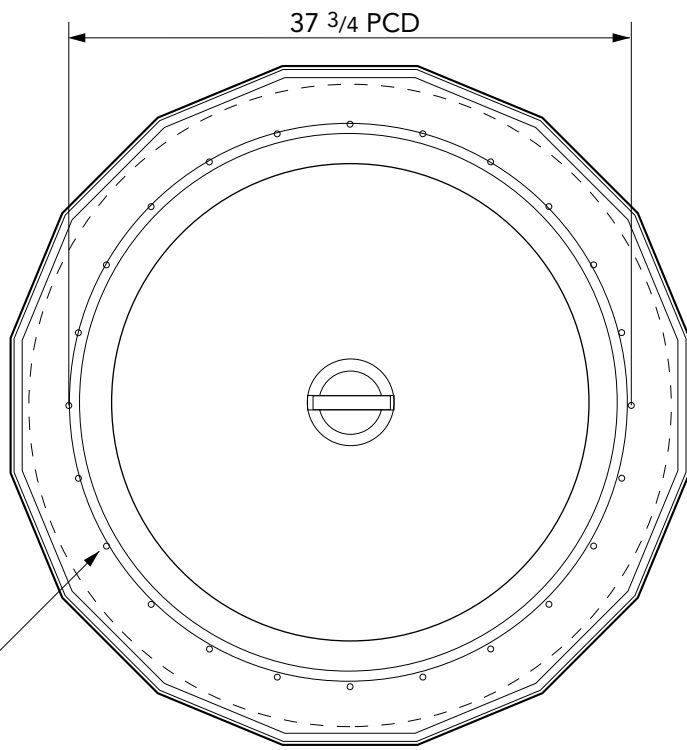

Notes:
 Minimum Wall Thickness 5.5mm
 Anti-Static Internal Face

Category: **HEIGHT ADJUSTABLE ROUND SUMP SYSTEMS**

Product Description: **47" diameter base sump with a sealed corbel, adjustable skirt and round 36" flat sealed cover. Round tank flange.**

For reference purposes only.
 This drawing is not a specification.

Drawing No: **US21224**

Date: **July 2003**

Product Code **S8-390/SEAL**

Revisions: **0**

